

Key

HEIGHT OF BUILDING IN FEET 57'
(C.B.)
NUMBER OF STORIES 4 BASEMENT B BRICK BASEMENT BB STONE " 8B
FRAME PARTITION
SLATE OR METAL ROOF
COMPOSITION ROOF
SHINGLE X ROOF
(BRICK 1ST) 2
D DWELLING
F FLAT
S STORE

Fire proof construction
 Hollow concrete or cement block construction
 Brick building with brick or metal cornice
 " " " frame cornice
 " " " stone front
 " " " frame side
 Brick veneered building
 Brick and frame building
 Frame building
 " " iron clad
 Stone building
 Fire wall 6 inches above roof

SKYLIGHT LIGHTING TOP STORY ONLY	12	"	"	"
SKYLIGHT LIGHTING THREE STORIES	24	"	"	"
SKYLIGHT WITH WIRED GLASS	36	"	"	"

Figures 8, 12, 16, 20 - indicate thickness of wall in inches.
 Wall without opening and size in inches
 " with openings, figures indicate on which floor
 Opening protected by single iron or iron clad doors.
 " " " double " " tin clad
 " " " wired glass doors
 " " " standard iron vault doors, or
 " " " standard tin clad doors.

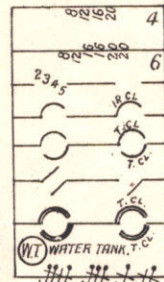

Windows protected by iron shutters.
 Windows protected by tin clad shutters
 Window opening in first story.
 " " " third "
 Windows " " second and fourth stories.
 " " with wired glass.
 Windows 1st & 2nd with iron shutters, 3rd & 4th with tin clad shutters and wired glass on 5th & 6th stories.

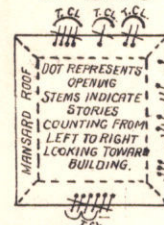

Windows 1st & 2nd with iron shutters, 3rd & 4th with tin clad shutters and wired glass on 5th & 6th stories.

		Hoistways	
		Elevators	
		Frame enclosed elevator	
		" " " with traps	
		" " " self closing traps	
		Brick enclosed elevator with traps	
		" " " self closing traps	
		" " " wired glass door	
		Steam boilers	
		Chimneys	
		Engine and horse power in figures	
		Water pipes and size in inches	
			Hydrants
			Vertical pipe or stand pipe
			" " with fire escape
			Force pump
			Elevation
			Automatic fire alarm
			Independent electric plant
			Stable
			Under sheet number, refers to corresponding sheet in previous edition
			Congested value district, shown thus:
			Blocks in which the conflagration hazard is pronounced, shown thus:
			Fire engine house, as shown on key map

573